



PROPERTY HIGHLIGHTS:

- High Identity on Alton Parkway
- Excellent Distribution Facility
- 31,956 SF
- 2,800 SF Office
- 5 Dock High Doors
- Possible GL Doors
- 26' Clear Height
- Sprinklered
- 400 Amps
- Possible Yard
- Parking on three (3) sides
- POL True DH 90,251 SF Building
- Excellent Access to 405 & 55 Fwys.

FOR MORE INFORMATION, PLEASE CONTACT:



Kevin Turner
Voit Real Estate Services
949-263-5391
kturner@voitco.com
Lic. #00968394

Michael Hartel
Voit Real Estate Services
949-263-5392
mhartel@voitco.com
Lic. #01031013

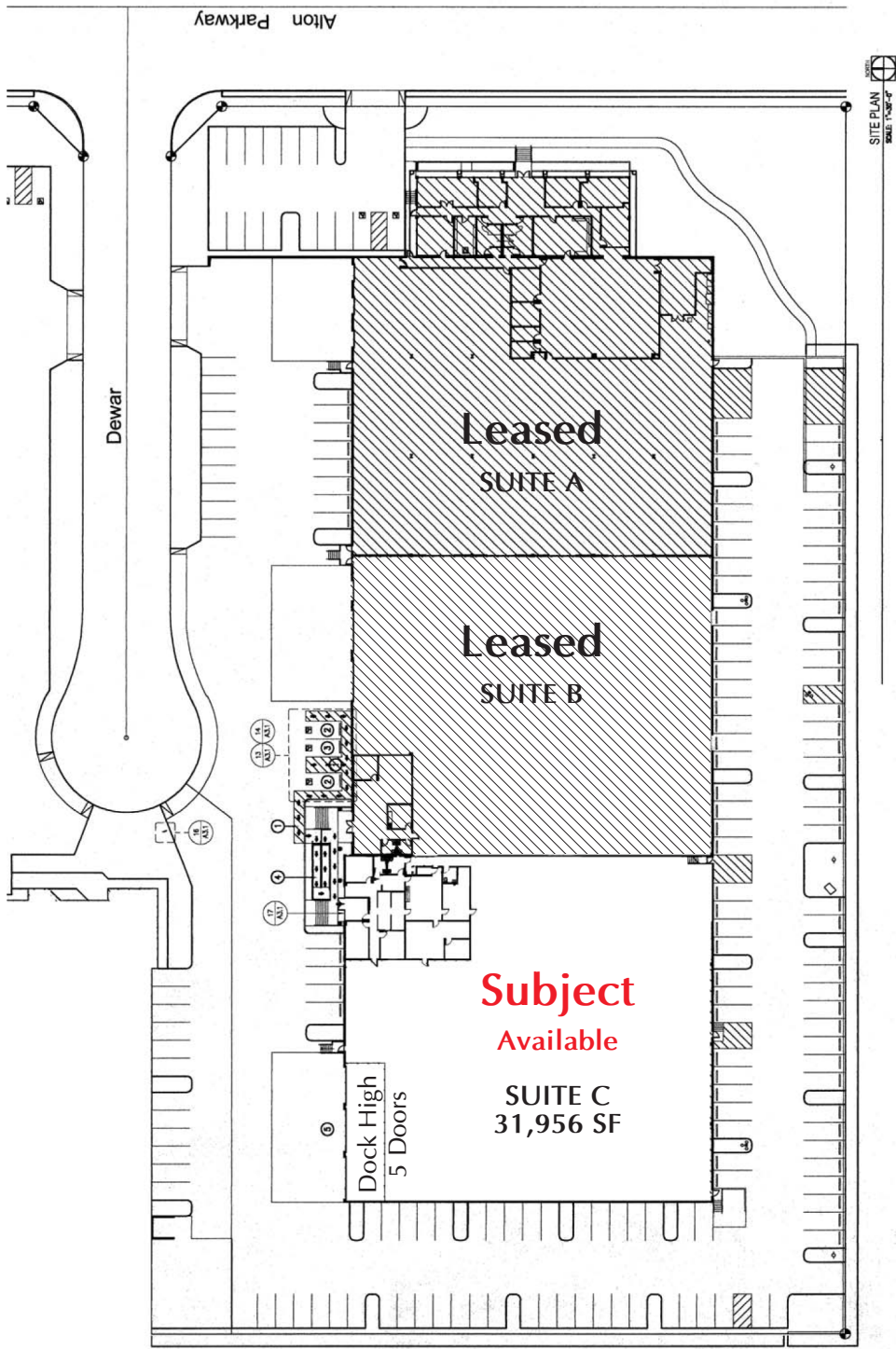

FOR MORE INFORMATION, PLEASE CONTACT:



Kevin Turner
Voit Real Estate Services
949-263-5391
kturner@voitco.com
Lic. #00968394

Michael Hartel
Voit Real Estate Services
949-263-5392
mhartel@voitco.com
Lic. #01031013